

Exhibition Floor Plan

LIFE Centre, Wapping Road, Bradford BD3 0EQ, 30 April - 1 May, 2025
 Call: **07860 926 404** Email: hello@societyoftissueviability.org

- 1
- 2
- 3
- 4
- 5
- 6
- 7
- 8
- 9
- 10
- 11
- 12 - Daylong
- 14
- 15
- 16
- 17
- 18
- 19
- 20/21 - Arjo
- 22 - Sigvaris
- 23
- 24 - Urgo
- 25 - MESI UK
- 26 - Activheal
- 27
- 28 - Smith + Nephew
- 29 - Hartmann
- 30 - B Braun
- 31
- 32
- 33/36 - Richardson H'care
- 34 - Essity
- 35 - Solventum
- 36
- 37
- 38 - Clinimed
- 39
- 40 - Convatec
- 41 - Evolan
- 42 - Firstkind Ltd
- 43 - Medi
- 44 - CD Medical
- 45
- 46 - L&R
- 47
- 48
- 49
- 50
- 51
- 52
- 53
- 54
- 55
- 56
- 57

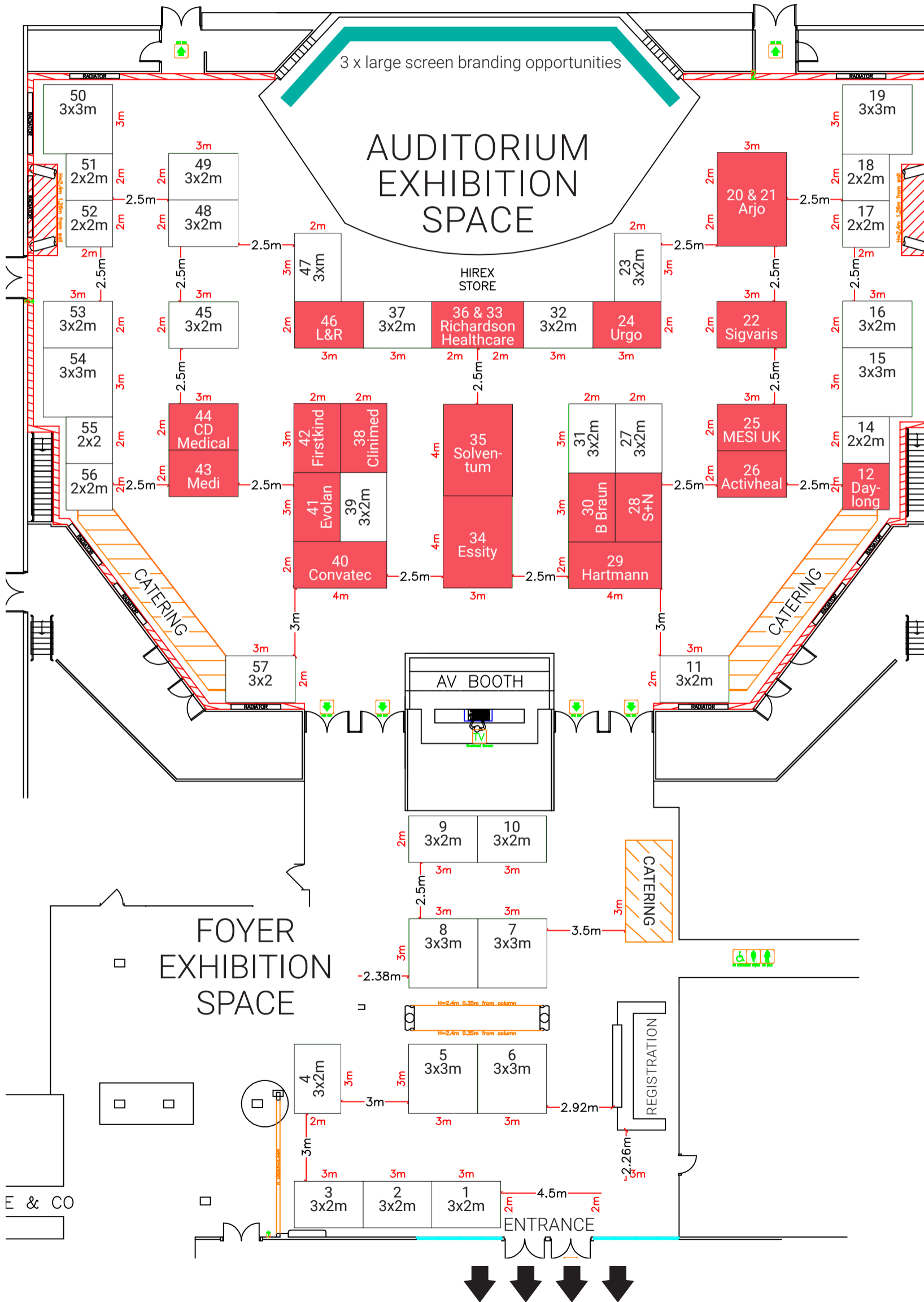

SCIENTIFIC SESSIONS ACROSS THE CAR PARK